

## Industrial Cableclamp Data Sheet

17 Series Industrial Cableclamp is available in Black LLDPE or Black Polymeric LSF (low smoke and fume) material, suffix 'LUL'

Material data sheets for : Black LLDPE and Black Polymeric LUL (LSF) are available upon request.

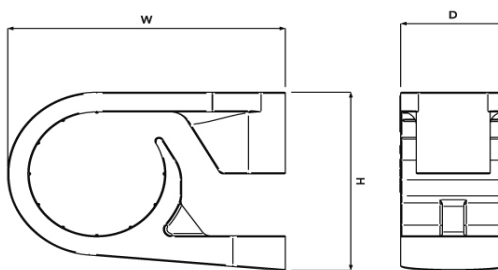

### Selection Table

Part No.		Cable Range		Dimensions mm				Pack Qty	SWL kgf	Weight g	
LLDPE	LUL	Min dia mm	Max dia mm	W	H	D	Fixing Hole			LLDPE	LUL
17-01B	17-01LUL	10	15	27.8	17.6	12	4.3	100	18	2.0	3.5
17-02B	17-02LUL	12	17	32.0	20.8	14	4.3	100	24	3.3	5.4
17-03B	17-03LUL	15	20	37.1	25.3	16	4.3	100	32	5.2	8.6
17-04B	17-04LUL	18	24	41.0	29.6	18	4.3	100	39	7.3	12.2
17-05B	17-05LUL	22	29	52.1	35.4	20	6.5	50	52	11.2	18.6
17-06B	17-06LUL	26	34	58.2	40.9	22	6.5	50	66	16.5	27.9
17-07B	17-07LUL	32	42	69.3	49.2	25	6.5	25	79	25.6	42.9
17-08B	17-08LUL	39	51	81.7	58.5	26	6.5	25	93	36.2	60.1



**London  
Underground**

The LUL version of this clamp is compliant with the requirements of London Underground Standard 1-085. Product Register No. 365