

# Orbit Cleat

## 379 Series



**The 379 series should be used when you need the best level of protection in the harshest environments under the highest fault conditions.**

### Features and Benefits

- Suitable for use with cable diameters 33 to 150mm.
- Single bolt fixing. Fixed to the support structure with a single bolt.
- Operating temperatures -40°C to +120°C.
- Ergonomic design allows easy installation with single tool tightening from the top side.
- Manufactured from non-magnetic, corrosion resistant 316L stainless steel.
- Liners are made from LSOH materials.
- Suitable for standard and LSOH cable sheaths.
- Can be used in harsh environments.
- Can be used with all standard ladder and tray systems.
- Complies with IEC 61914.

### Performance Data

| BS EN 61914           | Clause | Classification                 |
|-----------------------|--------|--------------------------------|
| Type                  | 6.1.3  | Composite                      |
| Operating Temperature | 6.2    | -40 °C to + 120 °C             |
| Impact Resistance     | 6.3    | V. Heavy                       |
| Needle Flame          | 10.1   | >120secs                       |
| Corrosion             | 6.5.2  | High, Outdoor - wet conditions |

\* Technical Information subject to change without notice

## Technical Data

| Cleat Selection |                |     | Cleat Details   |     |    |            |
|-----------------|----------------|-----|-----------------|-----|----|------------|
| Design Number   | Cable Diameter |     | Dimensions (mm) |     |    |            |
|                 | A (mm)         |     | B               | C   | D  | Weight (g) |
|                 | Min            | Max | Max             |     |    |            |
| 379SC01         | 33             | 40  | 65              | 86  | 60 | 435        |
| 379SC02         | 38             | 46  | 71              | 92  | 60 | 467        |
| 379SC03         | 45             | 53  | 78              | 99  | 60 | 499        |
| 379SC04         | 52             | 60  | 85              | 106 | 60 | 530        |
| 379SC05         | 59             | 67  | 92              | 113 | 60 | 526        |
| 379SC06         | 66             | 74  | 99              | 120 | 60 | 558        |
| 379SC07         | 72             | 82  | 111             | 132 | 60 | 639        |
| 379SC08         | 82             | 92  | 120             | 141 | 60 | 683        |
| 379SC09         | 92             | 103 | 130             | 151 | 60 | 737        |
| 379SC10         | 103            | 113 | 139             | 160 | 60 | 784        |
| 379SC11         | 113            | 123 | 148             | 169 | 60 | 850        |
| 379SC12         | 122            | 132 | 157             | 178 | 60 | 865        |
| 379SC13         | 131            | 141 | 165             | 177 | 60 | 908        |
| 379SC14         | 140            | 150 | 175             | 196 | 60 | 950        |

\* Technical information subject to change without notice

All cleats have a single central fixing hole for a 12mm diameter fixing bolt.

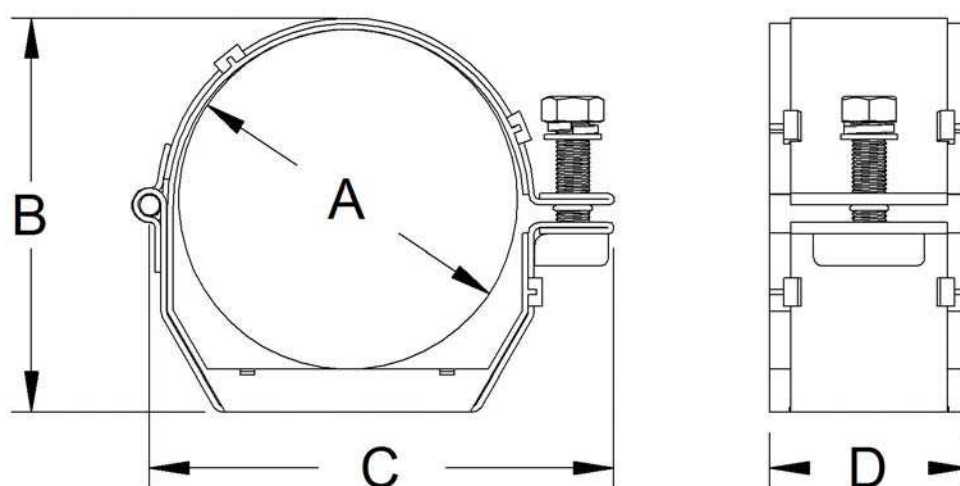

**Prysmian Cables & Systems Limited,**  
Oak Road, Wrexham Industrial Estate, Wrexham, LL13 9PH, UK

**Commercial Enquiries,**  
Sales Office Tel: 0845 767 8345,  
International Sales Office Tel: +44 2380 295481

[www.biconcomponents.co.uk](http://www.biconcomponents.co.uk)