



INSTALLATION INSTRUCTIONS FOR A2e / RA2e CABLE GLAND

CABLE GLAND FOR USE WITH UNARMoured AND BRAID ARMoured CABLES

INCORPORATING EU DECLARATION OF CONFORMITY TO DIRECTIVE [2014/34/EU]

CABLE GLAND TYPE A2e / RA2e

TECHNICAL DATA

CABLE GLAND TYPE : A2e / RA2e
INGRESS PROTECTION :
PROCESS CONTROL SYSTEM : BS EN ISO 9001
ISO/IEC 80079-34:2011

EXPLOSIVE ATMOSPHERES CLASSIFICATION

ATEX CERTIFICATION No : SIRA13ATEX1068X, SIRA13ATEX4074X
ATEX CERTIFICATION CODE : II 2G II 1D Ex e IIC Gb, Ex ta IIIC Da
IECEX CERTIFICATION No : II 3G Ex nR IIC Gc
IECEX CERTIFICATION CODE : IECEx SIR.13.0023X
IECEX CERTIFICATION CODE : Ex e IIC Gb, Ex ta IIIC Da, Ex nR IIC Gc

INSTALLATION INSTRUCTIONS

Installation should only be performed by a competent person using the correct tools. Spanners should be used for tightening. Read all instructions before beginning installation.

ACCESSORIES

The following accessories are from CMP Products, as optional extras, to assist with fixing, sealing and earthing:
Locknut, Earth Tag, Serrated Washer, Entry Thread (I.P.) Sealing Washer, Shroud

Cable Gland Size	Available Entry Threads (Alternate Metric Thread Lengths Available)					Overall Cable Diameter		RA2e Across Flats	RA2e Across Corners	A2e Across Flats	A2e Across Corners	Protrusion Length	Combined Ordering Reference (*Brass Metric)			Shroud	Cable Gland Weight (Kgs)
	Standard		Option		Min	Max	Max	Max	Max	Max	Size		Type	Ordering Suffix			
	Metric	Thread Length (Metric)	NPT	Thread Length (NPT)											NPT		
16	M16	10.0	-	-	-	3.2	8.7	27.0	29.7	24.0	26.4	28.2	16	RA2E	1RA	PVC02	0.060
20/16	M20	10.0	1/2"	19.9	3/4"	3.2	8.7	27.0	29.7	24.0	26.4	25.4	20/16	RA2E	1RA	PVC04	0.070
20/16	M20	10.0	1/2"	19.9	3/4"	6.1	11.7	27.0	29.7	24.0	26.4	25.4	20/16	RA2E	1RA	PVC04	0.060
20	M20	10.0	1/2"	19.9	3/4"	6.5	14.0	27.0	29.7	27.0	29.7	27.3	20	RA2E	1RA	PVC05	0.070
25	M25	10.0	3/4"	20.2	1"	11.1	20.0	36.0	39.6	36.0	39.6	35.8	25	RA2E	1RA	PVC09	0.130
32	M32	10.0	1"	25.0	1 1/4"	17.0	26.3	41.0	45.1	41.0	45.1	34.5	32	RA2E	1RA	PVC10	0.150
40	M40	15.0	1 1/4"	25.6	1 1/2"	23.5	32.2	50.0	55.0	50.0	55.0	35.7	40	RA2E	1RA	PVC13	0.200
50/5	M50	15.0	1 1/2"	26.1	2"	31.0	38.2	60.0	66.0	55.0	60.5	32.5	50/5	RA2E	1RA	PVC15	0.260
50	M50	15.0	2"	26.9	2 1/2"	35.6	44.0	60.0	66.0	60.0	66.0	36.3	50	RA2E	1RA	PVC18	0.270
63/5	M63	15.0	2"	26.9	2 1/2"	41.5	49.9	75.0	82.5	70.5	77.6	33.8	63/5	RA2E	1RA	PVC21	0.430
63	M63	15.0	2 1/2"	39.9	3"	47.2	55.9	75.0	82.5	75.0	82.5	36.0	63	RA2E	1RA	PVC23	0.400
75/5	M75	15.0	2 1/2"	39.9	3"	54.0	61.9	90.0	99.0	80.0	88.0	36.2	75/5	RA2E	1RA	PVC24	0.520
75	M75	15.0	3"	41.5	3 1/2"	61.1	67.9	89.0	97.9	84.0	92.4	40.9	75	RA2E	1RA	PVC26	0.500
90	M90	24.0	3 1/2"	42.8	4"	66.6	79.9	108.0	118.8	108.0	118.8	55.4	90	RA2E	1RA	PVC31	1.600
100	M100	24.0	3 1/2"	42.8	4"	76.0	91.0	123.0	135.3	123.0	135.3	55.4	100	RA2E	1RA	LSF32	1.780
115	M115	24.0	4"	44.0	5"	86.0	97.9	133.4	146.7	133.4	146.7	65.4	115	RA2E	1RA	LSF34	2.670
130	M130	24.0	5"	46.8	-	97.0	114.9	152.4	167.6	152.4	167.6	74.1	130	RA2E	1RA	LSF35	3.800

Dimensions are displayed in millimetres unless otherwise stated

Above ordering reference for RA2e, Remove 'R' for A2e with no face seal included

Standard Seal (Black) Temperature Range = -60°C to +130°C

High Temperature Seal (Brown) Temperature Range = -20°C to +200°C for High Temperature Seal add 'HT' to Ordering Reference after Gland Type e.g. 20SA2EHT1RA

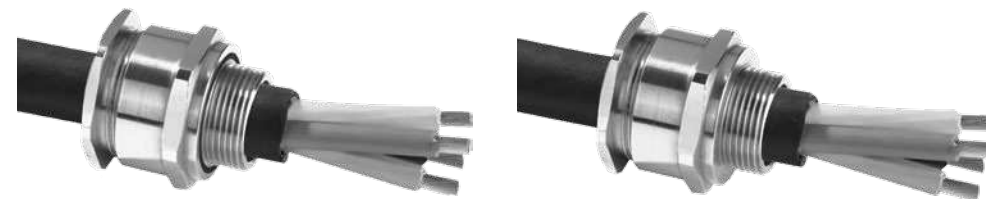

CMP Products Limited on its sole responsibility declares that the equipment referred to herein conforms to the requirements of the ATEX Directive 2014/34/EU and the following standards:

EN60079-0:2012, EN60079-1:2007, EN60079-7:2007, EN60079-15:2010, EN60079-31:2009, BS6121:1989, EN62444:2013

David Wilcock

David Wilcock – Certification Engineer (Authorised Person)
CMP Products Limited, Cramlington, NE23 1WH, UK
24th June 2015



A2e - no face seal
RA2e - with face seal



CE 0518

Notified Body: Sira Certification Service, Unit 6 Hawarden Industrial Park, Hawarden, CH5 3US, UK.

Glasshouse Street • St. Peters • Newcastle upon Tyne • NE6 1BS

Tel: +44 191 265 7411 • Fax: +44 1670 715646

E-Mail: customerservices@cmp-products.co.uk • Web: www.cmp-products.com



www.cmp-products.com



Logo's shown for illustration purposes only. Please check certification for details

INSTALLATION INSTRUCTIONS FOR CMP CABLE GLAND TYPES RA2e, A2e

CABLE GLAND COMPONENTS - It is not necessary to dismantled the cable gland any further than illustrated below

- 1. Entry Item
- 2. Seal
- 3. Seal Nut

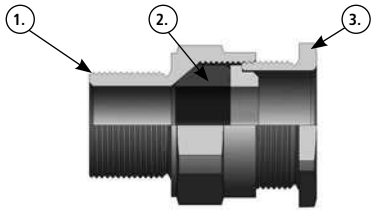

PLEASE READ ALL INSTRUCTIONS CAREFULLY BEFORE BEGINNING THE INSTALLATION

1. It is not necessary to dismantle the gland any further than illustrated below.



2. Fit the gland into the equipment and fully tighten the entry item (1).

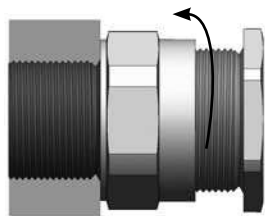

3. Determine the conductor length required to suit the installation and prepare the cable accordingly, removing part of the outer sheath where required to reveal the insulated conductors.



4. Slacken the seal nut (3) to relax the seal (2).

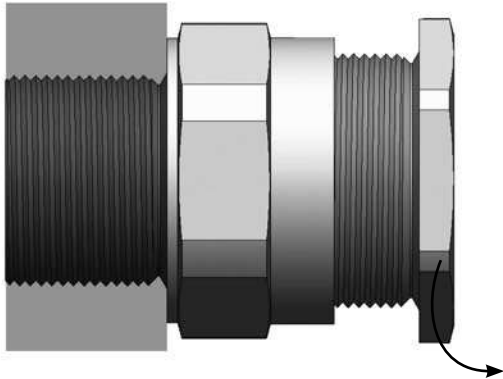

5. Pass the cable through the gland to the desired position, then tighten the seal nut by hand until resistance is felt (when the seal contacts the cable). Tighten with a spanner one further turn.

