

stokbord®

drum

User Guide



Innovative protection for underground
cables and pipelines

Designed and manufactured by



Centriforce Products Limited
14-16 Derby Road, Liverpool, L20 8EE

+44 (0)151 207 8109
sales@centriforce.co.uk
www.centriforce.com



Protecting buried utilities for over 40 years

Stokbord® Drum is a cable and pipeline protection cover, innovated from our globally recognised and specified Stokbord® Cover. Wound onto an industrial reel, Stokbord® Drum supplies the same trusted utility protection while improving installation safety and efficiency for workers and contractors.

Working collaboratively with our trusted partners, Centriforce developed Stokbord® Drum to support requirements for large scale utility projects.

Manufactured as a secure single strip, Stokbord® Drum does not require individual manual connections and removes the need for the trench. This advancement in buried utility protection promotes safety on site and assists project efficiency.



Installation of Stokbord® Drum at Triton Knoll Wind Farm

- Time saving installation
- Lower risk to operatives
- High impact resistance - does not shatter on impact
- Provides clear visual warning with bright colours and bold warning text
- Rot resistant and chemically inert meaning a long service life
- Conforms to internationally recognised standards
- Specified and approved by DNOs

Launched to acclaim in 2019, Stokbord® Drum has supported major engineering projects including Triton Knoll Wind Farm and Hornsea. Centriforce has received an incredible response from the industry - with customers and end-users commending Stokbord® Drum for its innovative approach to faster and safer installation.

Stokbord® Drum exhibits Centriforce's commitment to our policy of continual improvement. Our work with key utility organisations partnered with Centriforce's unrelenting drive in innovation has achieved this industry-changing product.

Laying Stokbord® Drum at Hornsea



Proudly supporting corporate environmental and sustainability policies, all Stokbord® products are manufactured from recycled polyethylene - saving waste material from landfill through high quality innovation.

Using & Installing Stokbord® Drum

While application may be subjective to each project depending on ground texture, weather conditions and machinery available, below we detail two suggested methods of installation which can be employed by end-users.

Please note that the following information acts as a recommendation only. See Important Information for reference.

Important Information:

Please be reminded that it is the responsibility of the end user to ensure that a risk assessment is completed before starting a drum installation process. Centriforce cannot accept responsibility for damage or events occurring as a result of following either method. This acts as a recommendation where this process may be adjusted for each individual application to meet safety and security requirements.

Before installing Stokbord Drum, please consult project specifications to ensure the required substrate depth sits between the buried cable or pipeline and the protection strip. As always, end users are required to perform a risk assessment prior to starting the drum installation process to ensure specified conditions and safety requirements are met.

Framed Installation

Stokbord® Drum can be mounted and suspended on an 'A'-frame or suitable screw jacks.

To install:

1. Ensure the drum is secured in selected mount and stationary in position without preventing reel rotation.
2. Once secured, the coach screws can be removed from the coil (perform with caution, as there may be some recoil as a result).
3. The material can be pulled from the drum into application using suitable equipment, an



Stokbord® Drum mounted on screw jacks



Stokbord® Drum secured in a lifting frame

Suspended Installation

Stokbord® Drum can be suspended above the trench using the arm of an excavator or similar machinery.

To install:

1. Use an appropriate device (eg. a suitable bar or frame) to bear the full weight of Stokbord® Drum (material and reel inclusive), secure through the barrel on either side of the drum.
2. Ensure each side is secured to avoid movement and prevent the product from falling during installation. **CONTINUED OVERLEAF**

Suspended Installation - Continued

3. Prior to suspension, remove the coach screws from the coil (perform with caution, as there may be some recoil as a result).
4. Once loose, secure the end section of Stokbord® Drum in place to prevent dragging or movement during installation. For example, a section of the material may be unwound from the drum and placed into the trench then held with backfill.



Excavator driving Stokbord® Drum into place



Stokbord® Drum held in place with backfill

5. Once securely suspended, the excavator can be slowly driven along the length of the trench, as the drum rotates to install the utility protection device in place.
6. To complete application into the trench, remove the coach screws attaching the material to the barrel of the drum. (Typically each drum will have two coach screws, depending on the width of the product)



Cutting & Rejoining Stokbord® Drum

There may be a time at which you need to remove a section from Stokbord® Drum. This may include accessing a buried cable or pipeline at a specific location, material testing, or replace a piece which may have become damaged. This guide provides a recommendation on how to cut and join a strip of Stokbord® Drum safely and securely.

REQUIRED PPE: Safety Glasses, Steel Toecap Shoes, Ear Protection, High Visibility Vest, Slash Resistant Gloves

To cut a section of cable cover strip, it is recommended to use a suitable cutting device such as a jig saw (right) or a circular saw. Safety is the top priority throughout this procedure, so it is recommended to use tools that do not apply concentrated pressure to the ground or utility services below.

Please see recommended directions below.



Example: Jig saw

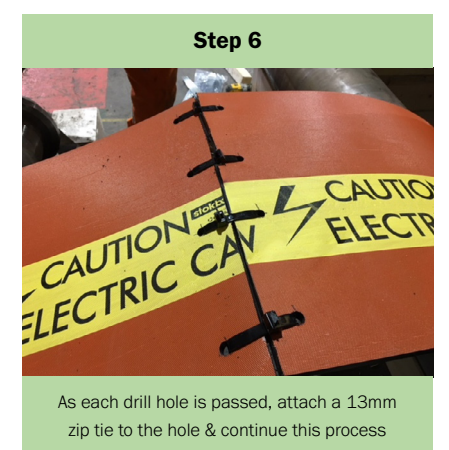
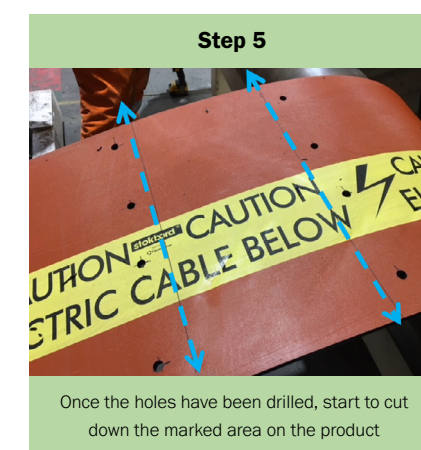
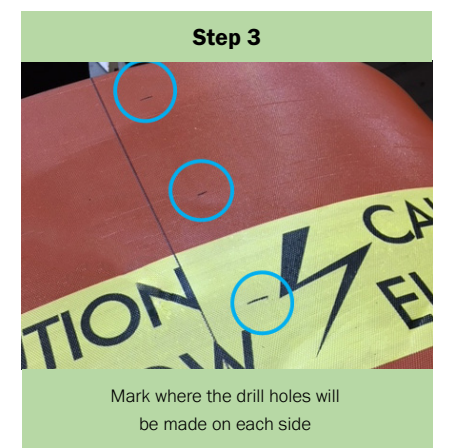
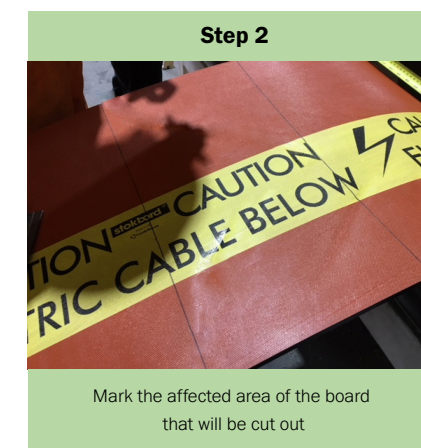
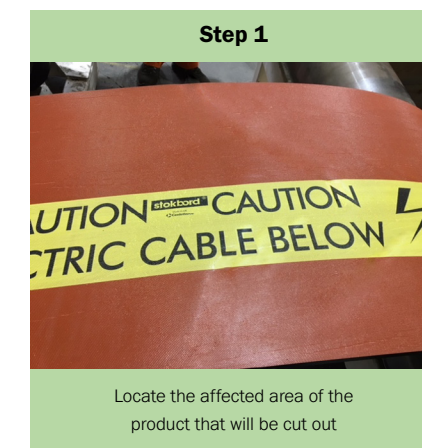

To re-join, drill 13mm sized holes across the ends of the removed section or replacement tile (the number of holes will depend on the width of the section), for a 500mm wide product we would suggest four holes at both ends. Then drill the same sized holes aligned with the holes in the section but in the main strips. Join using 13mm zip ties.

Our trusted utility protection range - over 40 years of innovation

stokbord®

Heavy duty mechanical protection for buried pipes and cables.

Stokbord® Covers provide heavy duty protection for buried services. Engineered with a high impact resistance, the covers have been specifically developed to withstand damage from plant and tools. They provide a highly visible and durable protective warning against possible accidental damage and injury.

- High impact resistance, tough and durable
- Approved and used by utilities companies worldwide for over 30 years
- Lightweight, flexible and easy to handle
- Manufactured from 100% recycled plastic



tapetile®

Highly visible mechanical protection for all buried utilities.

Tapetile® offers more protection than traditional warning tape. Highly visible, it provides a measure of mechanical protection against damage to utilities. Tapetile® is easy to use, with installation being a simple matter of unrolling the tape in the trench.

- Offers a degree of impact resistance to excavation tools
- Provides clear visual warning with bright colours and bold warning text
- Rot resistant and chemically inert meaning a long service life
- Manufactured from 100% recycled plastic

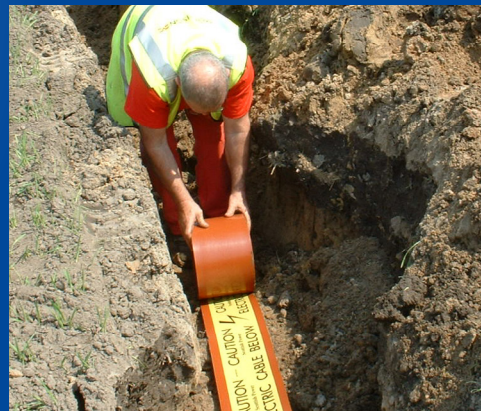

locata®

Detectable and highly visible underground warning tape and mesh.

Locata® detectable tapes and mesh are designed to provide an early warning to excavators and prevent damage to buried service lines. Locata® tapes and mesh can also be detectable above ground using cable avoidance tools and utility locators.

- Lightweight, flexible, easy to handle and install
- Manufactured using high grade polymers
- Can be combined with Stokbord® cover range for added assurance
- Custom option available



For more information email info@centriforce.co.uk or call our Customer Service Team on 0151 207 8109.



Certification ID
10061212 for ISO9001
10118909 for ISO14001
10005533 for OHSAS18001

Designed and manufactured by

