



LINK BOX TECHNICAL DATA SHEET

Drw. No. 04.07.04
Article No. 05504001/0

Issued Date: 10.05.2019
Rev. Date: 4.08.2021
Rev. 02

Type	LB. U . SB .3SA . 3 . 1		
- Description	Three Phase S.Point Bonding Link Box for Coaxial Cable		
- Designation	Underground		
- Bonding	Single Point		
- Sheath Voltage Limiter	qty	3	
- Phase No.	3		
Earth	1		
Drawing Number	04.07.04		
- Article No	05504001/0		
Electrical Characteristics			
- Rated Frequency	50/60	Hz	
- SVL Type (*)	Up to 18 kV / Optional		
Protection Class			
IP 68			
Material			
- Enclosure	Stainless Steel AISI304 (AISI316 optional)		
- Body Thickness (**)	2 mm		
- Cover Thickness	3 mm		
- Connection Links	10 µm Tinned Electrolytic Copper		
- Connection Links Dimension	40x10 mm (400 mm2)		
- Gasket	Silicone		
- Cable Glands	3x76 mm & 1x48 mm		
- Cable Glands Insulation	Silicone gasket & EPR tape & Mastic Tape & Heat Shirinkable Tube		
- Insulation	Epoxy Support Insulator		
- Conductor Fixing	Coaxial Flexconn - 95-400 mm2		
- Painting Process	Electro Static Polyester Powder Paint		
- Painting Code	RAL 7032		
- Labeling Material	Stainless Steel		
- Protection Cover	PET-G		
AC Impulse Test			
- Phase-to-Phase	75	kV	
- Phase-to-Earth	40	kV	
Voltage Withstand Test			
- AC	20	kV/1 min	
- DC	25	kV/5 min	
Short Circuit Test			
- Symmetrical	50	kA/1sec	
Internal Power Arcing Test (Symmetrical)			
	40	kA/0.1 sec	

* In case of mismatch in given values, technical drawing provided along with the Order Confirmation is valid. Ask for conformity if SVL is out of EMELEC's scope.

** Body Thickness might differ related to technical drawing revision. For exact value, refer to technical drawing provided along with the Order Confirmation

Bonding Cable

- Type										Coaxial
Gland Dia		A		B		C		D		
Cross-Section:	Outer	Inner	min	max	min	max	min	max	min	max
(mm ²)	(mm)	(mm)	(mm)	(mm)	(mm)	(mm)	(mm)	(mm)	(mm)	(mm)
95-400	76	72	12	24	20	36	25	48	30	64

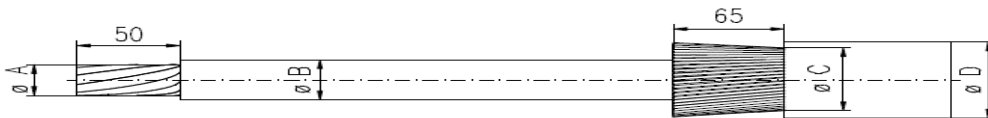

Schematic Diagram

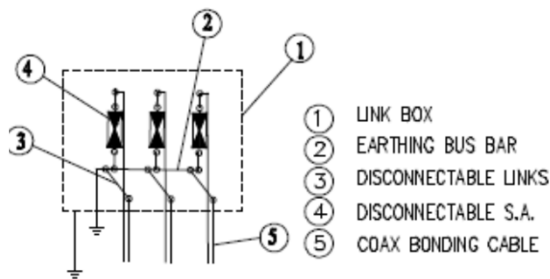

Enclosure Dimensions (*)

Width	690 mm
Length	670 mm
Height	354 mm
Weight	80 kg

Filling Compound (Optional)

Volume	57 lt (**)
--------	------------

* Scheme and dimensions are not to be mentioned as final drawing. For exact dimensions, refer to technical drawing provided along with the Order Confirmation
** Given are approximate values. Actual values might slightly differ.