



## LINK BOX TECHNICAL DATA SHEET

Drw. No. **04.09.07**  
 Article No. **05707001/0**

*Issued Date:* 10.05.2019  
*Rev. Date:* 4.08.2021  
*Rev.* 03

Type	LB. U . E . 3 . 1	
- Description	Three Phase Earthing Bonding Link Box for Coaxial Cable	
- Designation	Underground	
- Bonding	Earthing	
- Sheath Voltage Limiter	N/A	
- Phase No.	3	
Earth	1	
Drawing Number	04.09.07	
- Article No	05707001/0	
Electrical Characteristics		
- Rated Frequency	50/60	Hz
- SVL Type (*)	N/A	
Protection Class		
	IP	68
Material		
- Enclosure	Stainless Steel AISI304 (AISI316 optional)	
- Body Thickness (**)	2 mm	
- Cover Thickness	3 mm	
- Connection Links	10 µm Tinned Electrolytic Copper	
- Connection Links Dimension	40x10 mm (400 mm2)	
- Gasket	Silicone	
- Cable Glands	3x76 mm & 1x48 mm	
- Cable Glands Insulation	Silicone gasket & EPR tape & Mastic Tape & Heat Shrinkable Tube	
- Insulation	Epoxy Support Insulator	
- Conductor Fixing	Coaxial Flexconn - 95-400 mm2	
- Painting Process	Electro Static Polyester Powder Paint	
- Painting Code	RAL 7032	
- Labeling Material	Stainless Steel	
- Protection Cover	PET-G	
AC Impulse Test		
- Phase-to-Phase	N/A	kV
- Phase-to-Earth	40	kV
Voltage Withstand Test		
- AC	20	kV/1 min
- DC	25	kV/5 min
Short Circuit Test		
- Symmetrical	50	kA/1sec
Internal Power Arcing Test (Symmetrical)		
	40	kA/0.1 sec

\* In case of mismatch in given values, technical drawing provided along with the Order Confirmation is valid. Ask for conformity if SVL is out of EMELEC's scope.

\*\* Body Thickness might differ related to technical drawing revision. For exact value, refer to technical drawing provided along with the Order Confirmation

**Bonding Cable**

- Type										Coaxial
Gland Dia		A		B		C		D		
Cross-Section (mm <sup>2</sup> )	Outer (mm)	Inner (mm)	min (mm)	max (mm)	min (mm)	max (mm)	min (mm)	max (mm)	min (mm)	max (mm)
95-400	76	72	12	24	20	36	25	48	30	64

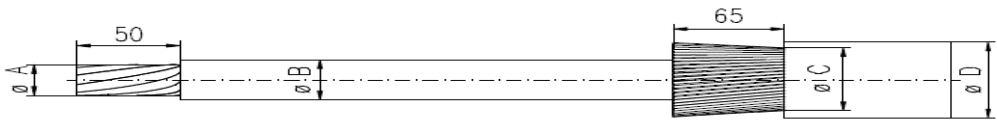

**Schematic Diagram**

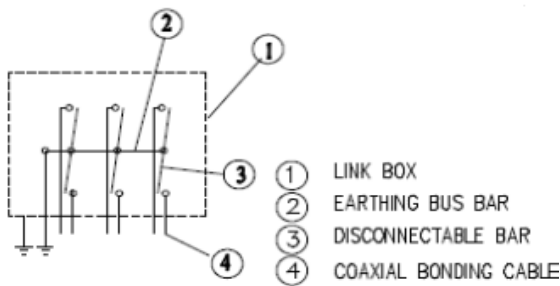

**Enclosure Dimensions (\*)**

Width	690 mm
Length	670 mm
Height	334 mm
Weight	68 kg

**Filling Compound (Optional)**

Volume	57 lt (**)
--------	------------

\* Scheme and dimensions are not to be mentioned as final drawing. For exact dimensions, refer to technical drawing provided along with the Order Confirmation  
\*\* Given are approximate values. Actual values might slightly differ.