

MR4 Edge Mount Manhole Lead In Cable Roller

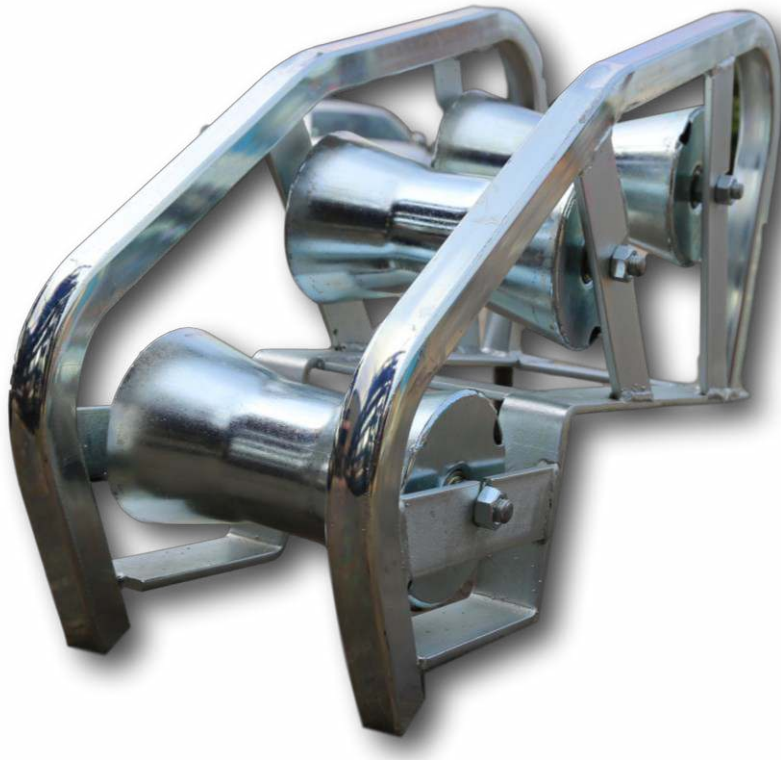

The MR4 manhole cable roller leads the cable from the drum into the jointbox/manhole or the winch bond out of the manhole. The cable roller is suitable for cables of up to 130mm

- Heavy duty tubular steel construction
- 3 off 110mm diameter steel roller*
- Precision sealed roller bearings fitted
- Zinc plated or powder coated finish
- Size: 57cm long x 21cm wide x 40cm high
- Weight: 10Kg

* The diablo rollers can be substituted with a heavy gauge 89mm tubular steel roller fitted with oil impregnated maintenance free bushes when using the heaviest of cables